



Madison Water Utility
119 E. OLIN AVE.
MADISON, WI 53713

CITY OF MADISON

MADISON WATER UTILITY

PUBLIC WORKS PLAN OF PROPOSED IMPROVEMENT

PUBLIC IMPROVEMENT PROJECT APPROVED

APPROVED DATE: 4/25/2023

BY THE COMMON COUNCIL OF MADISON, WISCONSIN

PUBLIC IMPROVEMENT DESIGN APPROVED BY:

5/11/2023

Pete Holmgren, PE
Chief Engineer - Madison Water Utility

WATER DESIGNED BY:

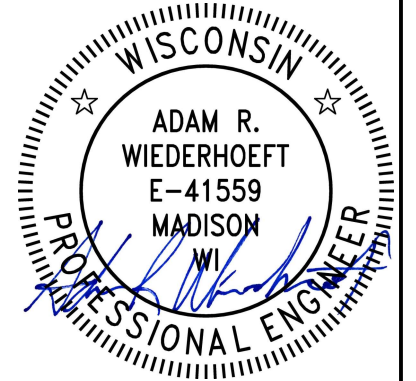

5/12/2023

INDEX OF SHEETS

SHEET NO.	1	TITLE SHEET
SHEET NO.	W-1	PROJECT AREA OVERVIEW
SHEET NO.	W-2 TO W-4	WATER LINING & BYPASS PLAN

CIPP 2023 FISH HATCHERY ROAD

CITY PROJECT NO. 14643
CONTRACT NO. 9319

PROJECT LOCATION

CONVENTIONAL SIGNS
FIELD VERIFY ALL UTILITY LOCATIONS

- WATER MAIN TO BE LINED
- BYPASS 2-IN OR LARGER
- BIKE PATH CONCRETE
- BYPASS AREA W/ LINING
- WATER

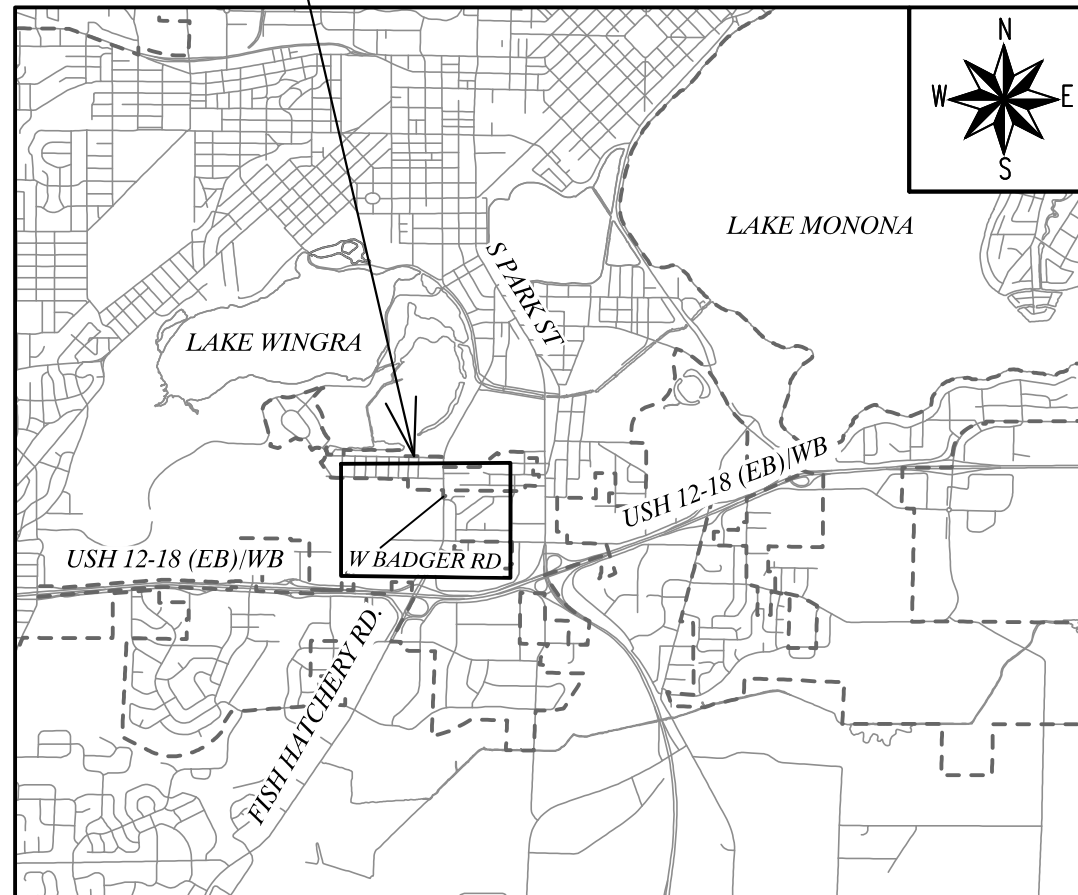

PLOT SCALE: 1" = 1'

PLOT NAME:

REV. DATE: 5/10/2023 11:39 AM

ORIGINATOR: CITY_OF_MADISON



UNIVERSITY OF WISCONSIN
MADISON ARBORETUM

IMPACTED PROPERTY
ON BYPASS SYSTEM

WASTE MANAGEMENT
RECYCLING PLANT

BRIDGE CAPACITY
~20,000 LBS

SITE ACCESS EAST
OF BRIDGE ON
FISH HATCHERY RD

SITE ACCESS WEST
OF BRIDGE

RAILROAD

RAILROAD

RAILROAD

FISH HATCHERY RD

CATALPA RD

W BADGER RD

FISH HATCHERY RD

PETRA PL

EMIL ST

SCALE: 1" = 225'
DESIGNED BY: RJN
MADISON WATER UTILITY
119 E OLIN AVE, MADISON, WI 53713
PRINTING DATE: 5/10/23

CONTRACT NO: 9319

CIPP 2023 FISH HATCHERY RD
PROJECT AREA OVERVIEW
CITY OF MADISON, WISCONSIN



14643
W-1

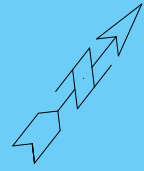

EXCAVATION
PIT #1

STORM CROSSING
CLEARANCE ~ 3FT

EXCAVATION
PIT #2

EXCAVATION
PIT #3

450' of 12" PVC

170' of 12" PVC

530' of 12" PVC

W
BADGER RD

SCALE: 1" = 80'
DESIGNED BY: RJN
MADISON WATER UTILITY
119 E OLIN AVE, MADISON, WI 53713
PRINTING DATE: 5/10/23

CONTRACT NO: 9319

CIPP 2023 FISH HATCHERY RD
PIPE LINING PLAN
CITY OF MADISON, WISCONSIN



14643

W-2

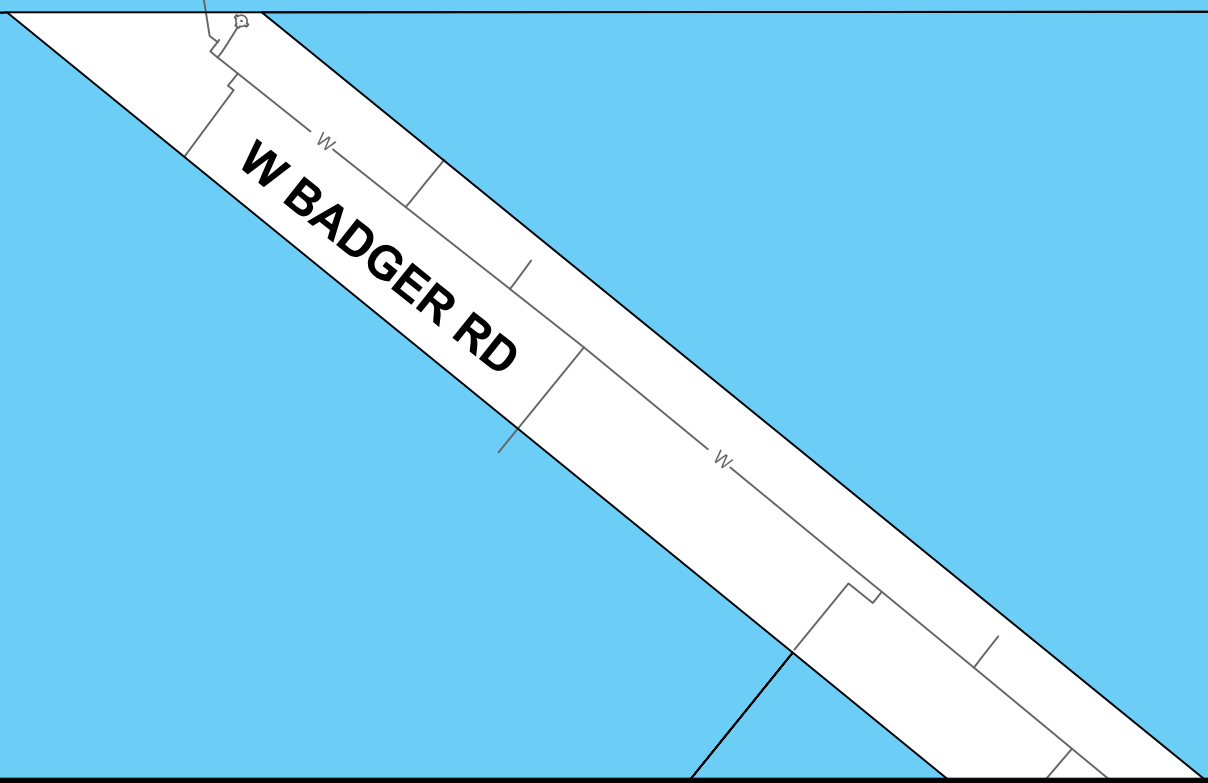
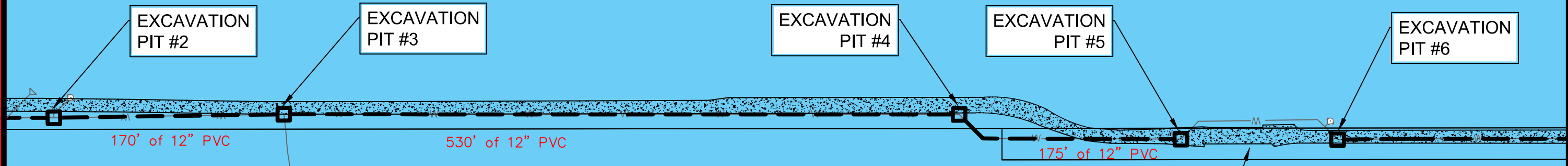
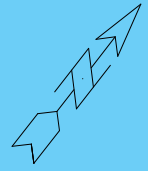

BRIDGE CAPACITY
~20,000 LBS

EXCAVATION
PIT #2

EXCAVATION
PIT #3

EXCAVATION
PIT #4

EXCAVATION
PIT #5

EXCAVATION
PIT #6

170' of 12" PVC

530' of 12" PVC

175' of 12" PVC

W BADGER RD

SCALE: 1" = 80'
DESIGNED BY: RJN
MADISON WATER UTILITY
119 E OLIN AVE, MADISON, WI 53713
PRINTING DATE: 5/10/23

CONTRACT NO: 9319

CIPP 2023 FISH HATCHERY RD
PIPE LINING PLAN
CITY OF MADISON, WISCONSIN



14643
W-3

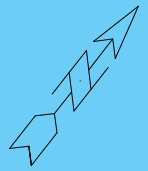
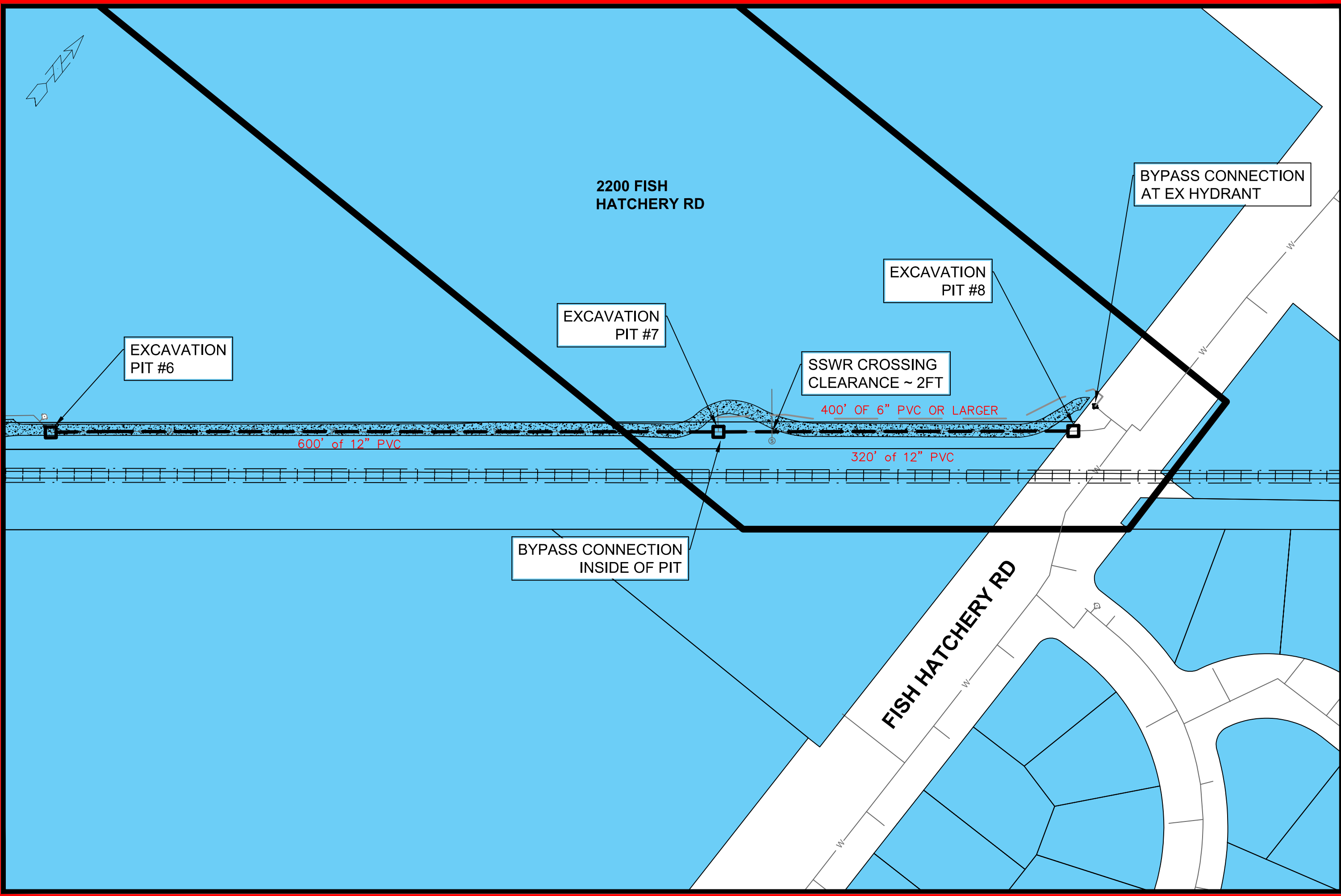

2200 FISH
HATCHERY RD

BYPASS CONNECTION
AT EX HYDRANT

EXCAVATION
PIT #8

EXCAVATION
PIT #7

SSWR CROSSING
CLEARANCE ~ 2FT

EXCAVATION
PIT #6

600' of 12" PVC

400' of 6" PVC OR LARGER

320' of 12" PVC

BYPASS CONNECTION
INSIDE OF PIT

FISH HATCHERY RD

SCALE: 1" = 80'
DESIGNED BY: RJN
MADISON WATER UTILITY
119 E OLIN AVE, MADISON, WI 53713
PRINTING DATE: 5/10/23

CONTRACT NO: 9319

CIPP 2023 FISH HATCHERY RD
PIPE LINING & BYPASS PLAN
CITY OF MADISON, WISCONSIN



14643
W-4